

BID DOCUMENT DRAWINGS

PLAN REPRODUCTION WARNING

THE PLANS HAVE BEEN CREATED ON ANSI D (22"x34") SHEETS. FOR REDUCTIONS, REFER TO GRAPHIC SCALE.

THE PLANS HAVE BEEN CREATED FOR FULL COLOR PLOTTING. ANY SET OF THE PLANS THAT IS NOT PLOTTED IN FULL COLOR SHALL NOT BE CONSIDERED ADEQUATE FOR CONSTRUCTION PURPOSES.

****WARNING**:** INFORMATION MAY BE LOST IN COPYING AND/OR GRAY SCALE PLOTTING.



4815 List Drive, Unit 115
Colorado Springs, CO 80919
Phone: 719-632-3593
www.kleinfelder.com



REVISIONS

REV	DESCRIPTION	DSN DWN	CHK APP	DATE

PROJECT CONTACT

DESIGN CONSULTANT

KLEINFELDER
CONTACT: JG McCALL
4815 LIST DRIVE, UNIT 115
COLORADO SPRINGS, COLORADO 80919
719-632-3593
JGMCCALL@KLEINFELDER.COM

LIBRARY 21C

1175 CHAPEL HILLS DR.
COLORADO SPRINGS, CO 80920

SHEET INDEX	
SHEET NO.	DESCRIPTION
1	COVER SHEET AND MAP
2	PAVEMENT REPAIR PLAN
3	GRADING PLAN
4	SITE ASSET AND STRIPING PLAN
5-6	ADA CHECK PLAN
7	SIDEWALK RAMP
8	PHASING PLAN
9-10	DETAILS

RFC 10/28/2016



SCALE VERIFICATION

THIS BAR IS 1 INCH IN LENGTH ON ORIGINAL DRAWING



IF IT'S NOT 1 INCH ON THIS SHEET ADJUST YOUR SCALES ACCORDINGLY

ORIGINAL DRAWING SIZE IS 22 x 34

COVER SHEET AND MAP



LIBRARY 21C
1175 CHAPEL HILLS DR.
COLORADO SPRINGS, CO 80920

BID DOCUMENT DRAWINGS

PROJECT NO.	20164613	SHEET	1
ISSUE DATE	10/26/2016		
CURRENT REVISION	-		
DESIGNED BY	MRS		
DRAWN BY	MRS		
CHECKED BY	JTM		
APPROVED BY	SJMS		1 of 10



VICINITY MAP
NOT TO SCALE

THIS PLAN SET IS BASED ON CAD AERIAL PHOTOGRAPHY.

THE CONTRACTOR IS SPECIFICALLY CAUTIONED THAT THE EXISTING UTILITIES INFORMATION SHOWN ON THESE PLANS IS NOT TO BE RELIED ON AS BEING EXACT OR COMPLETE. THE CONTRACTOR WILL BE RESPONSIBLE FOR FIELD VERIFYING LOCATIONS AND DEPTHS OF EXISTING UTILITIES BEFORE COMMENCING CONSTRUCTION. THE CONTRACTOR MUST ALSO CALL 811 AT LEAST 3 WORKING DAYS BEFORE ANY EXCAVATION TO REQUEST EXACT FIELD LOCATION OF UTILITIES.

SITE IMPROVEMENTS LEGEND

- 4" HMA OVER 3" EXISTING ABC, SEE NOTE 1-3 (145,000 SQ FT)
- 6" PCC OVER 6" ABC, SEE NOTE 1-3 (5,500 SQ FT)
- REGRADE ADA AREA PER ADA PAVEMENT NOTES ON THIS SHEET (2,550 SQ FT)
- CONCRETE REMOVE & REPLACE WITH ADA COMPLIANT ACCESSIBLE ROUTE (790 SQ FT)
- REMOVE AND REPLACE CURB AND GUTTER PER DETAIL 4 ON SHEET 9 (170 LF)
- P-# X.X" AC EXISTING PAVEMENT SECTION THICKNESS

EXISTING PAVEMENT SECTION THICKNESS		
LOCATION	AC THICKNESS (IN.)	ABC THICKNESS (IN.)
P-1	4.0	4.0
P-2	3.0	3.0
P-3	3.0	3.0

PAVEMENT REHABILITATION NOTES:

1. THE PAVEMENT REHABILITATION DETAILS ARE PRESENTED IN THE KLEINFELDER PAVEMENT EVALUATION REPORT PPLD LIBRARY 21C DATED AUGUST 10, 2016.
2. ALL PAVEMENT REHABILITATION WORK MUST COMPLY WITH PIKES PEAK REGION PAVING SPECIFICATIONS UNLESS NOTED OTHERWISE.
3. CONTRACTOR SHALL SUBMIT MIX DESIGN TO THE ENGINEER FOR APPROVAL SEVEN (7) DAYS PRIOR TO THE BEGINNING OF PAVEMENT OPERATION. THE MIX DESIGN SHALL BE DEVELOPED USING THE CDOT SUPERPAVE MIX DESIGN PROCEDURES PER SECTION 403.03 OF THE "STANDARD SPECIFICATION FOR ROAD AND BRIDGE CONSTRUCTION".
4. REMOVAL AND REPLACEMENT OF AGGREGATE BASE MAY BE REQUIRED TO ACHIEVE PROPOSED ASPHALT SECTION THICKNESS AND MAINTAIN POSITIVE DRAINAGE FROM LIBRARY.
5. ASPHALT SHALL BE PLACED IN THE DIRECTION OF TRAFFIC. SEE SHEET 8 FOR DIRECTION OF TRAFFIC.
6. FOR PAVEMENT REHABILITATION DETAILS SEE SHEET 9 AND 10.
7. REMOVE AND REPLACE CONCRETE SIDEWALK RAMP INSTALLED PER DETAILS ON SHEET 7.
8. SEE SHEET 8 FOR PHASING PLAN.

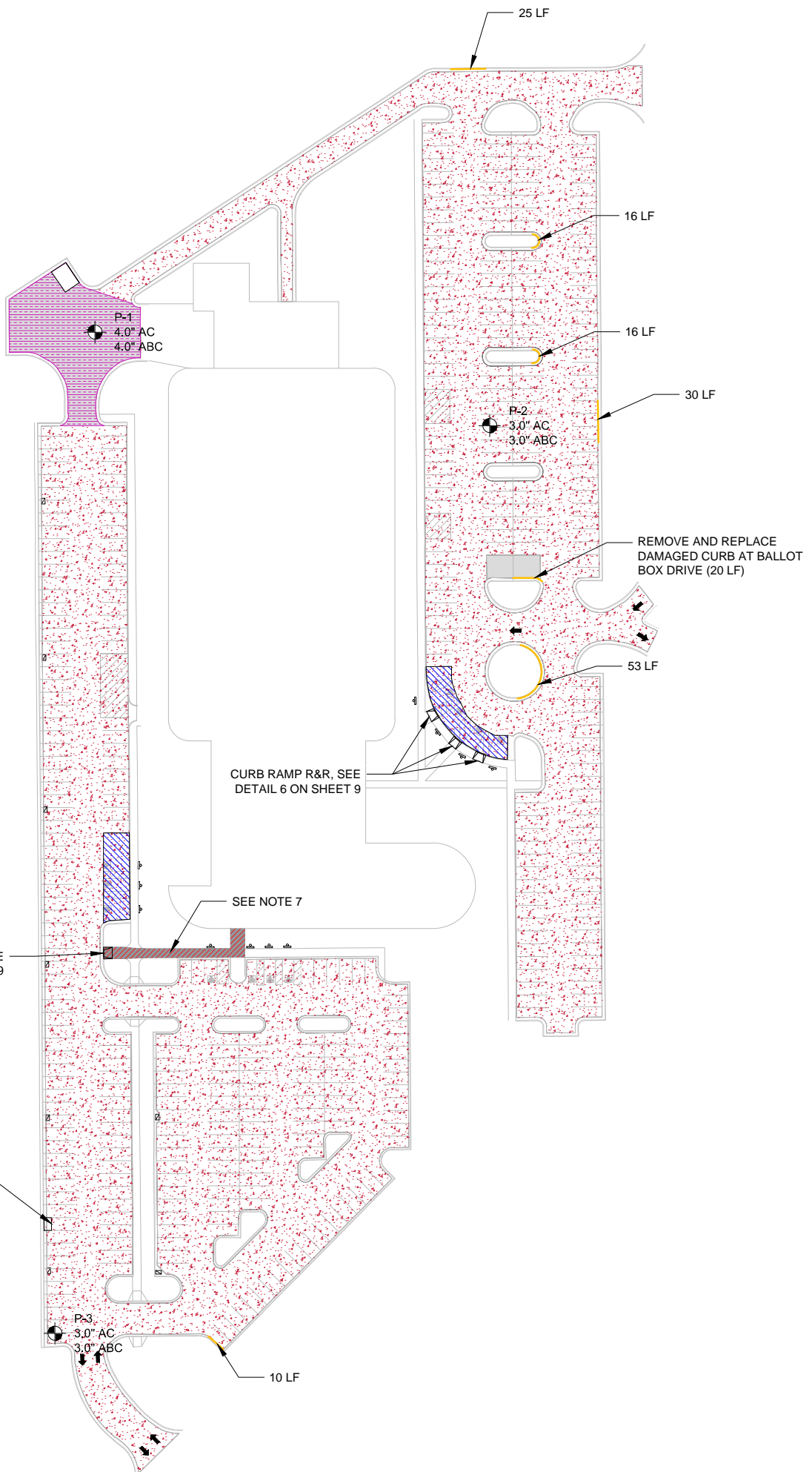

ADA PAVEMENT NOTES

1. THE CONTRACTOR ASSUMES RESPONSIBILITY THAT ALL ELEMENTS ARE CONSTRUCTED IN ACCORDANCE WITH FEDERAL ADA STANDARDS (2010 ADA).
 - A. ALL ACCESSIBLE ROUTES SHALL BE CONSTRUCTED WITH A RUNNING SLOPE NOT STEEPER THAN 1:20 AND A CROSS SLOPE NOT STEEPER THAN 1:48 (2010 ADA SECTION 403.3).
 - B. ALL CHANGES IN LEVEL ON AN ACCESSIBLE ROUTE GREATER THAN 1/4", OR 1/2" IF BEVELED AT A 1:2 SLOPE, SHALL BE RAMPED, AND SHALL COMPLY WITH 2010 ADA 405 OR 406. (2010 ADA SECTIONS 303.2, 303.3, 303.4).
 - C. ALL DOOR MANEUVERING CLEARANCE AREAS, RAMP LANDINGS, PARKING STALLS, AND ACCESS AISLES SHALL HAVE NO SLOPES EXCEEDING 1:48, AND NO CHANGES IN LEVEL (2010 ADA SECTIONS 404.2.4.4, 405.7.1, 502.4).
 - D. ALL RAMPS SHALL BE CONSTRUCTED WITH A RUNNING SLOPE NOT STEEPER THAN 1:12, AND A CROSS SLOPE NOT STEEPER THAN 1:48 (2010 ADA SECTIONS 405.2, 405.3).
 - E. OTHER THAN CROSS SLOPE AND RUNNING SLOPE, THERE SHALL BE NO CHANGE IN LEVEL ALONG THE ENTIRE RAMP RUN (2010 ADA SECTION 405.4).
 - F. THE RISE FOR ANY RAMP RUN SHALL BE 30 INCHES MAXIMUM (2010 ADA SECTION 405.6).
 - G. ALL RAMPS SHALL BE CONSTRUCTED WITH A LANDING ON THE TOP AND BOTTOM OF EACH RUN (2010 ADA SECTION 405.7).
 - H. RAMP RUNS WITH A RISE GREATER THAN 6 INCHES SHALL HAVE A HANDRAIL INSTALLED (2010 ADA SECTION 405.8). THE HANDRAIL SHOULD COMPLY WITH 2010 ADA SECTION 505.
 - I. ON ALL CURB RAMPS THE COUNTER SLOPE SHALL NOT BE GREATER THAN 1:20, AND THE FLARES SHALL NOT BE GREATER THAN 1:10 OR, IN THE CASE OF A RAMP WITH NO LANDING, 1:12 (2010 ADA SECTIONS 406.2, 406.3, 406.4).
 - J. THE BOTTOM OF ALL PARKING SPACE IDENTIFICATION SIGNS SHALL BE A MINIMUM OF 60 INCHES ABOVE THE FINISH FLOOR OR GROUND SURFACE (2010 ADA SECTION 502.6).
2. THE PAVEMENT REPAIR AREA WAS ESTIMATED BASED ON DIGITAL LEVEL AND/OR LASER LEVEL DATA. THE CONTRACTOR SHALL VERIFY THAT THE SLOPES AS DESIGNED ARE CONSTRUCTED TO BE COMPLIANT WITH THE 2010 ADA. ACCORDINGLY, THE PAVEMENT REPAIR AREA MAY NEED TO BE ADJUSTED IF DIFFERENT CONDITIONS ARE ENCOUNTERED DURING CONSTRUCTION.
 3. THE FOLLOWING ARE STANDARD DESIGN SLOPES THAT HAVE BEEN ADOPTED TO ALLOW FOR VARIABILITY IN CONSTRUCTION TOLERANCES:
- | ELEMENT | CROSS SLOPE | RUNNING SLOPE |
|--------------------------------|-------------|---------------|
| CONCRETE ACCESSIBLE ROUTES | 1.8% | 4.8% |
| ASPHALT ACCESSIBLE ROUTES | 1.5% | 4.5% |
| CONCRETE ACCESSIBLE PARKING | 1.8% | 1.8% |
| ASPHALT ACCESSIBLE AREA | 1.5% | 1.5% |
| CONCRETE RAMPS | 1.8% | 7.8% |
| CONCRETE LANDINGS AND DOORWAYS | 1.8% | 1.8% |
4. KLEINFELDER RECOMMENDS THE OWNER CONDUCT A POST-CONSTRUCTION ASSESSMENT OF THE ADA ELEMENTS FOR COMPLIANCE WITH THE 2010 ADA.



REVISIONS				
REV	DESCRIPTION	DSN DWN	CHK APP	

RFC 10/28/2016

SCALE VERIFICATION

THIS BAR IS 1 INCH IN LENGTH ON ORIGINAL DRAWING

IF IT'S NOT 1 INCH ON THIS SHEET ADJUST YOUR SCALES ACCORDINGLY

ORIGINAL DRAWING SIZE IS 22 x 34

SITE REPAIR PLAN

LIBRARY 21C
1175 CHAPEL HILLS DR.
COLORADO SPRINGS, CO 80920

BID DOCUMENT DRAWINGS		
PROJECT NO.	20164613	SHEET
ISSUE DATE	10/26/2016	
CURRENT REVISION	-	
DESIGNED BY	MRS	2
DRAWN BY	MRS	
CHECKED BY	JTM	
APPROVED BY	SJMS	

CAD FILE: W:\2016\4613 - Library 21c Pavement Repair Plan\21c Pavement Repair Plan\21c Pavement Repair Plan.dwg LAYOUT: 2 Pavement Repair Plan



REVISIONS

REV	DESCRIPTION	DSN	CHK	DATE

RFC 10/28/2016

SCALE VERIFICATION

THIS BAR IS 1 INCH IN LENGTH ON ORIGINAL DRAWING

SCALE: 1" = 10'

ORIGINAL DRAWING SIZE IS 22 x 34

GRADING PLAN

LIBRARY 21c
PUEBLO PEAK LIBRARY DISTRICT

LIBRARY 21c
1175 CHAPEL HILLS DR.
COLORADO SPRINGS, CO 80920

BID DOCUMENT DRAWINGS

PROJECT NO.	20164613	SHEET	3
ISSUE DATE	10/26/2016		
CURRENT REVISION	-		
DESIGNED BY	MRS		
DRAWN BY	MRS		
CHECKED BY	JTM		
APPROVED BY	SJMS		

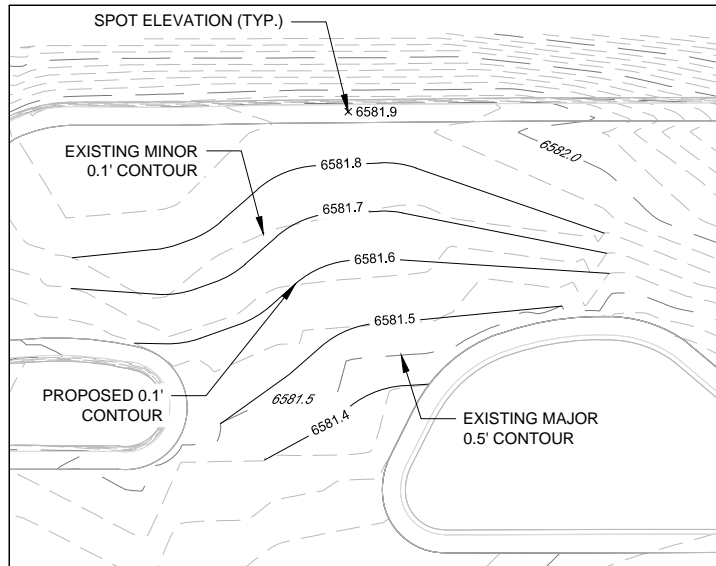

① GRADING AREA 1

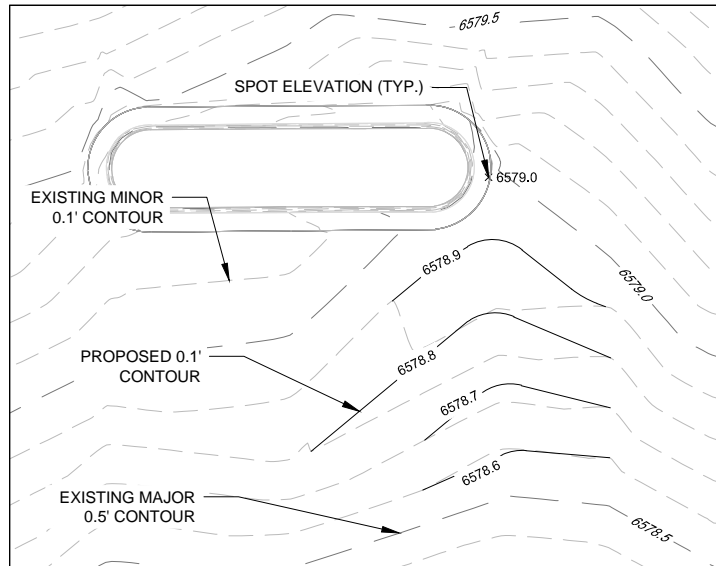

② GRADING AREA 2

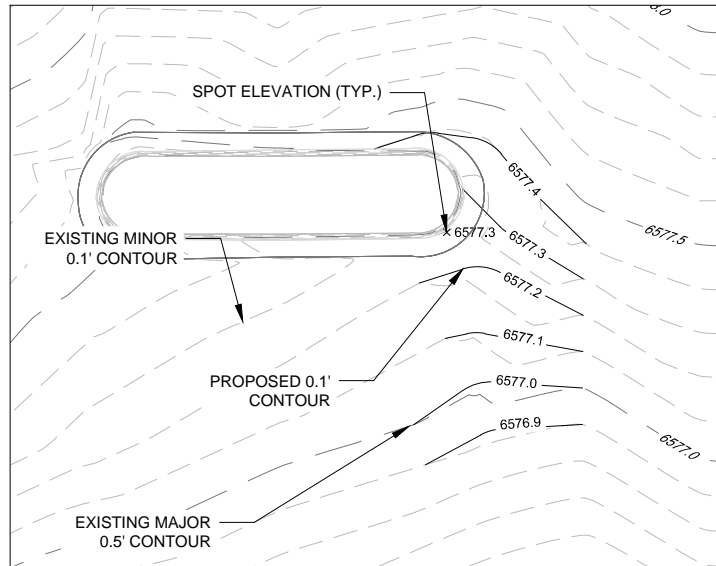

③ GRADING AREA 3

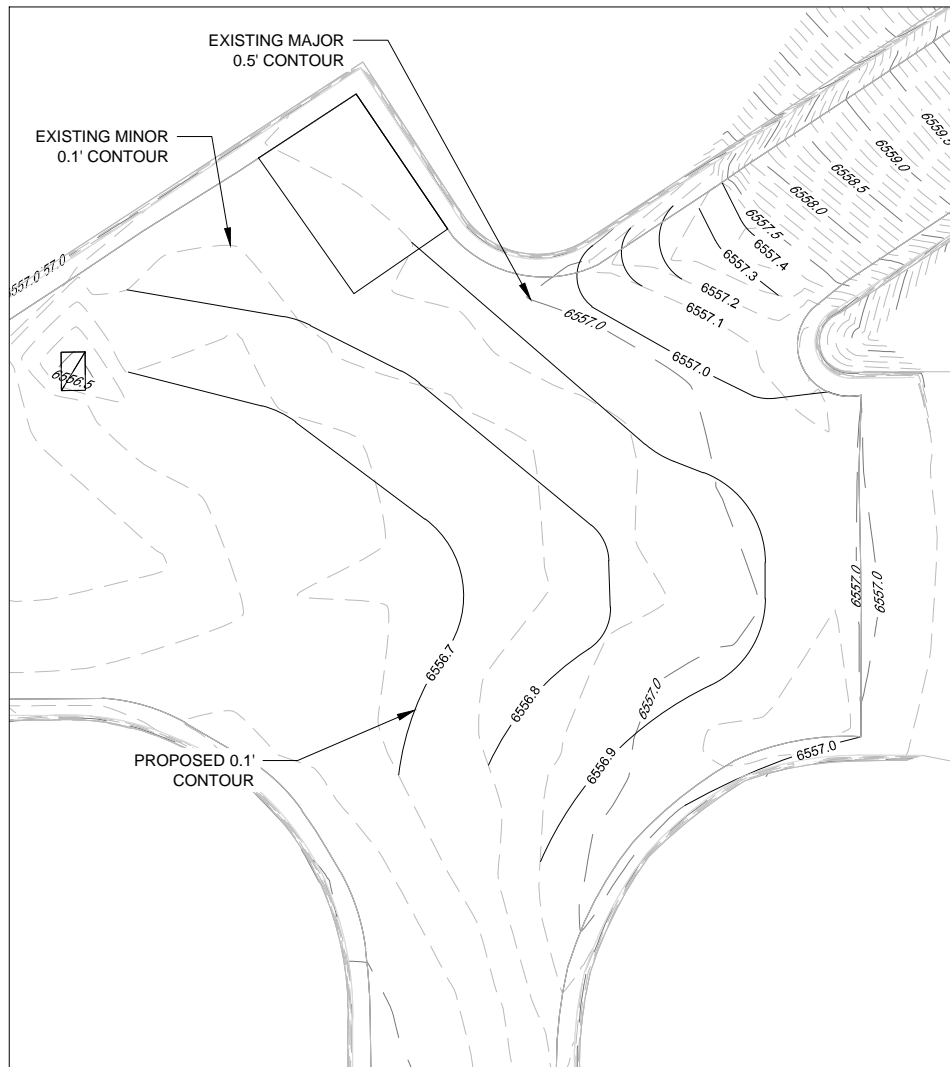

④ GRADING AREA 4

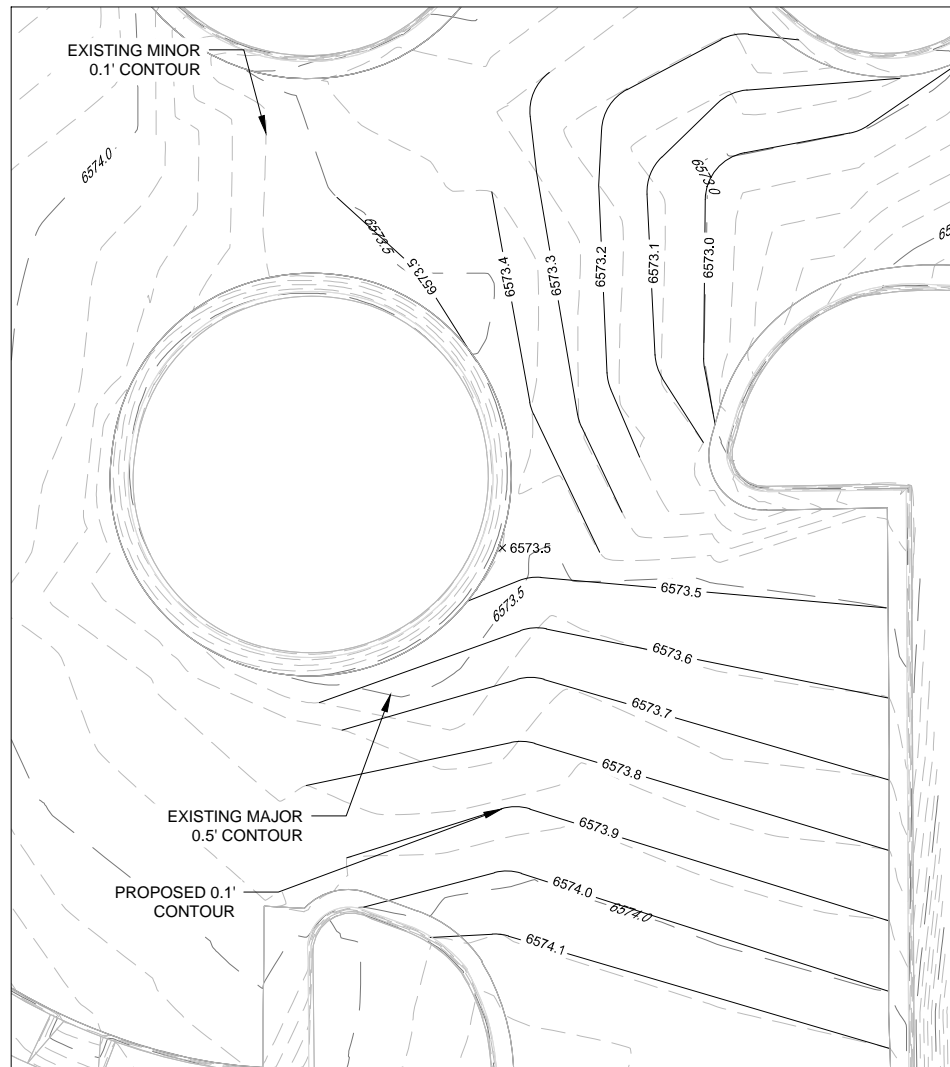

⑤ GRADING AREA 5

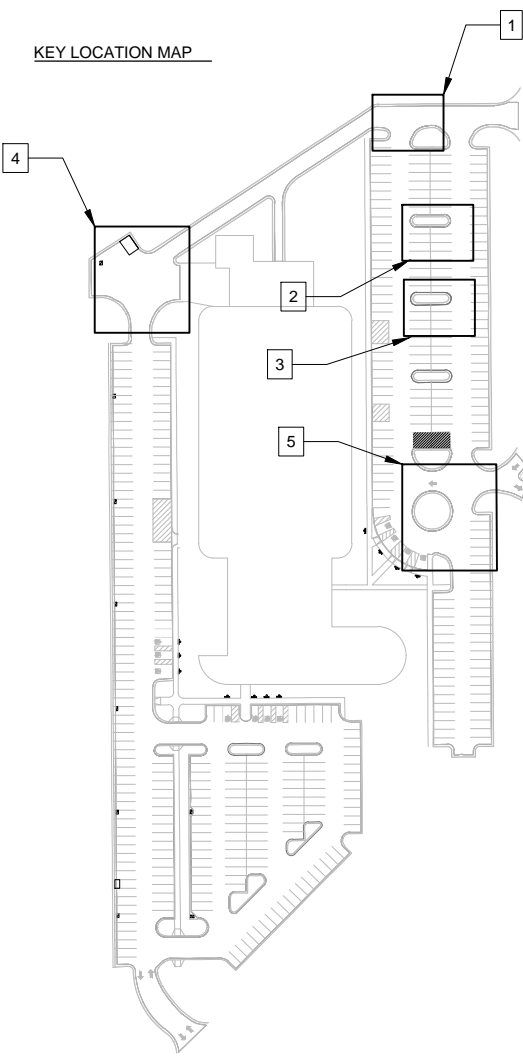

CAD FILE: W:\20164613 - Library 21c Pavement Repair Plan\21c Technical And CADD Figures\Library 21c 80% Plans.dwg LAYOUT: 3 Grading plan

CAD FILE: W:\2016\64613 - Library 21c Pavement Repair Plan\21c Plans\21c Site Asset and Striping Plan LAYOUT: 4 Site Asset and Striping Plan

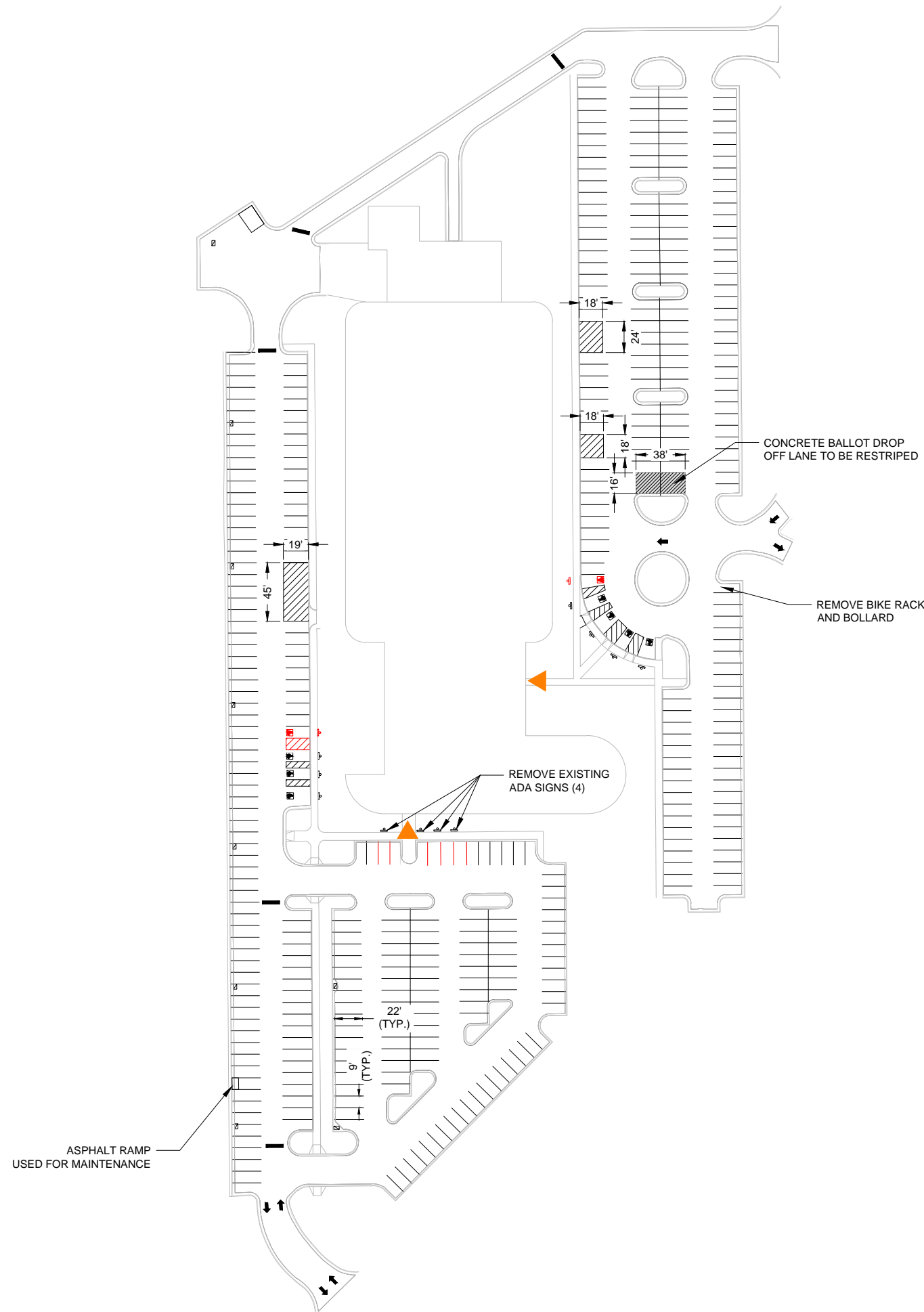

SITE IMPROVEMENTS LEGEND

- INSTALL ADA SIGN AND POST (2)
- NEW LAYOUT STRIPING
- EXISTING/PROPOSED STRIPING (SEE NOTES BELOW)
- PUBLIC ENTRANCE / EXIT
- INSTALL 16' LONG SPEED BUMP (5)
SEE DETAIL 5 ON SHEET 9

NOTES:

ALL ITEMS THAT WERE ORIGINALLY PAINTED, STENCILED, OR STRIPED SHOULD BE REPAINTED, STENCILED, OR STRIPED WITH THE SAME COLOR AND DIMENSIONS PER TYPICAL STRIPING DETAILS 8 AND 9 ON SHEET 9.

PARKING STALL COUNT		
	EXISTING	PROPOSED
VAN ACCESSIBLE STALLS	2	2
TOTAL ADA STALLS	11	9
TOTAL STALL COUNT	419	403



1801 California Street, Suite #1100
Denver, CO 80202
Phone: 303-237-6601
www.kleinfelder.com



REVISIONS

REV	DESCRIPTION	DSN DWN	CHK APP	DATE

RFC 10/28/2016

SCALE VERIFICATION

THIS BAR IS 1 INCH IN LENGTH ON ORIGINAL DRAWING

IF IT'S NOT 1 INCH ON THIS SHEET ADJUST YOUR SCALES ACCORDINGLY

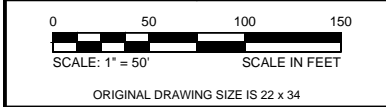

SITE ASSET AND STRIPING PLAN

LIBRARY 21C
1175 CHAPEL HILLS DR.
COLORADO SPRINGS, CO 80920

BID DOCUMENT DRAWINGS		
PROJECT NO.	20164613	SHEET
ISSUE DATE	10/26/2016	
CURRENT REVISION	-	
DESIGNED BY	MRS	4
DRAWN BY	MRS	
CHECKED BY	JTM	
APPROVED BY	SJMS	



REVISIONS

REV	DESCRIPTION	DSN	CHK	DATE

RFC 10/28/2016

SCALE VERIFICATION

THIS BAR IS 1 INCH IN LENGTH ON ORIGINAL DRAWING

IF IT'S NOT 1 INCH ON THIS SHEET ADJUST YOUR SCALES ACCORDINGLY

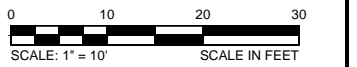

ORIGINAL DRAWING SIZE IS 22 x 34

ADA CHECK PLAN



LIBRARY 21C
1175 CHAPEL HILLS DR.
COLORADO SPRINGS, CO 80920

BID DOCUMENT DRAWINGS

PROJECT NO.	20164613	SHEET	
ISSUE DATE	10/26/2016		
CURRENT REVISION	-		
DESIGNED BY	MRS		
DRAWN BY	MRS		5
CHECKED BY	JTM		
APPROVED BY	SJMS		

EXISTING LEGEND

- EXISTING CONDITIONS
- X.X% EXISTING NON-COMPLIANT SLOPE
- X.X% EXISTING SLOPE

KEY LOCATION MAP

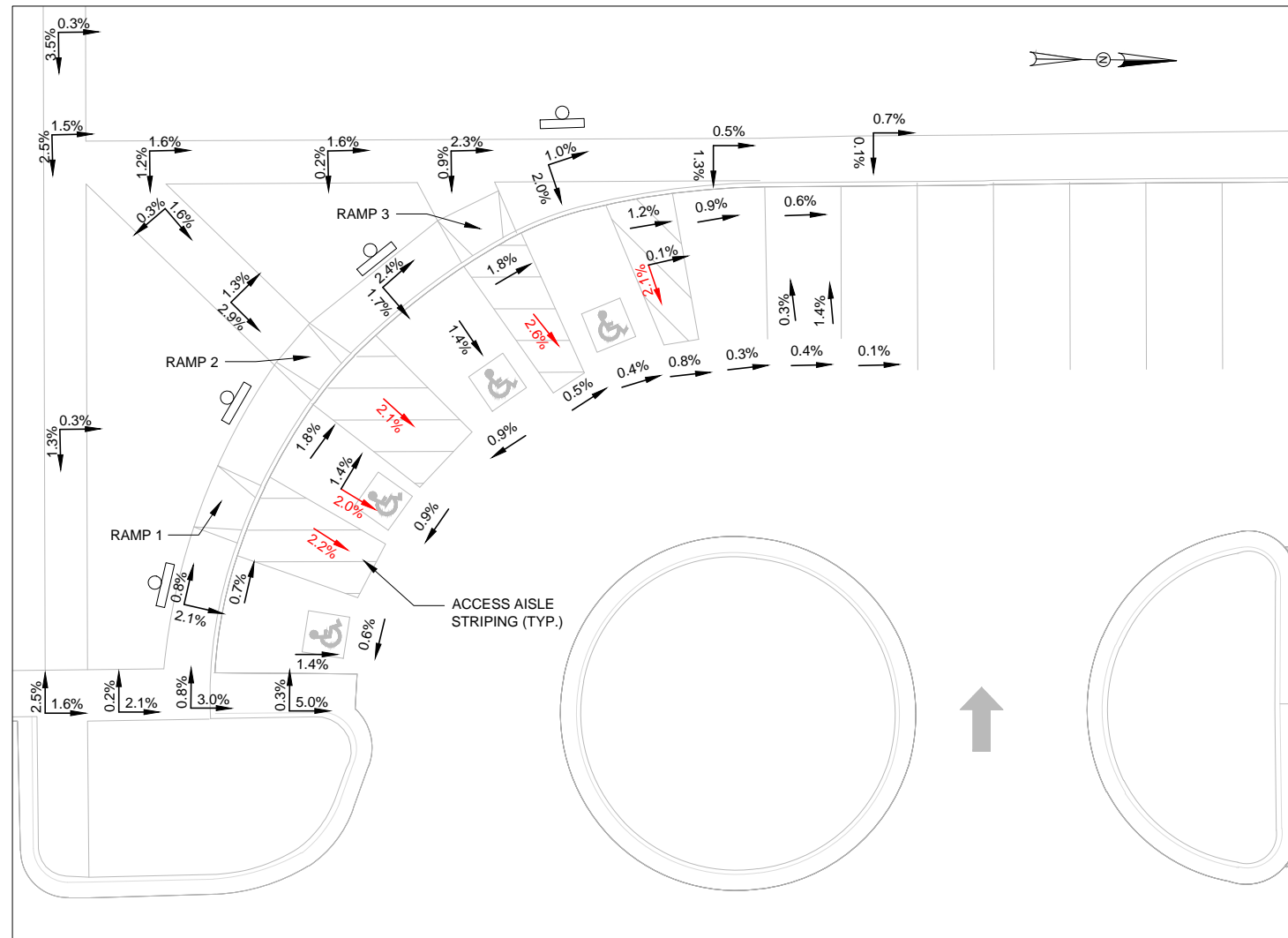
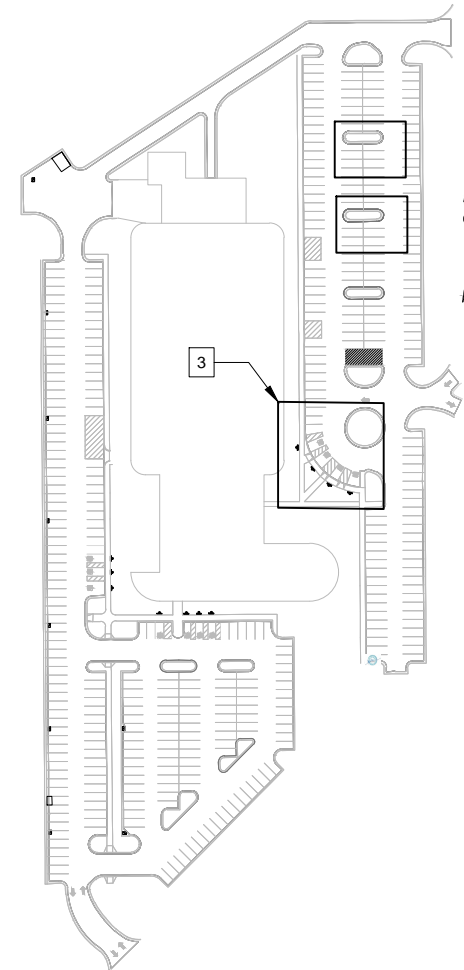

AREA 3

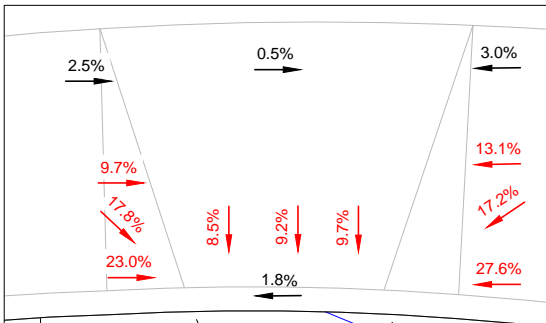

RAMP 1

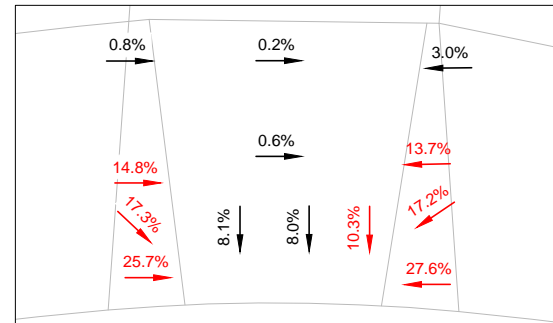

RAMP 2

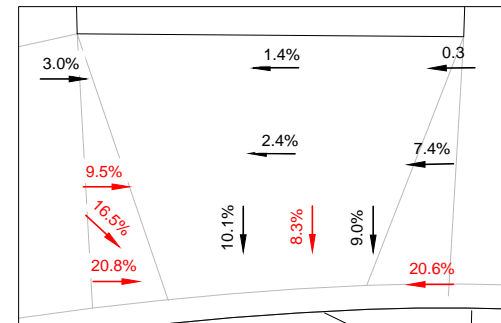

RAMP 3

NOTES:

- CURB RAMPS WITH NON-COMPLIANT SLOPE SHALL BE REMOVED AND REPLACED ACCORDING TO CURB RAMP DETAIL 6 ON SHEET 9.
- NON-COMPLIANT ADA PARKING STALLS AND ACCESS AISLES SHALL BE REGRADED TO MEET BUT NOT EXCEED THE FOLLOWING SLOPES:

ELEMENT	CROSS SLOPE	RUNNING SLOPE
CONCRETE ACCESSIBLE ROUTES	1.8%	4.8%
ASPHALT ACCESSIBLE ROUTES	1.5%	4.5%
CONCRETE ACCESSIBLE PARKING	1.8%	1.8%
ASPHALT ACCESSIBLE AREA	1.5%	1.5%
CONCRETE RAMPS	1.8%	7.8%
CONCRETE LANDINGS AND DOORWAYS	1.8%	1.8%

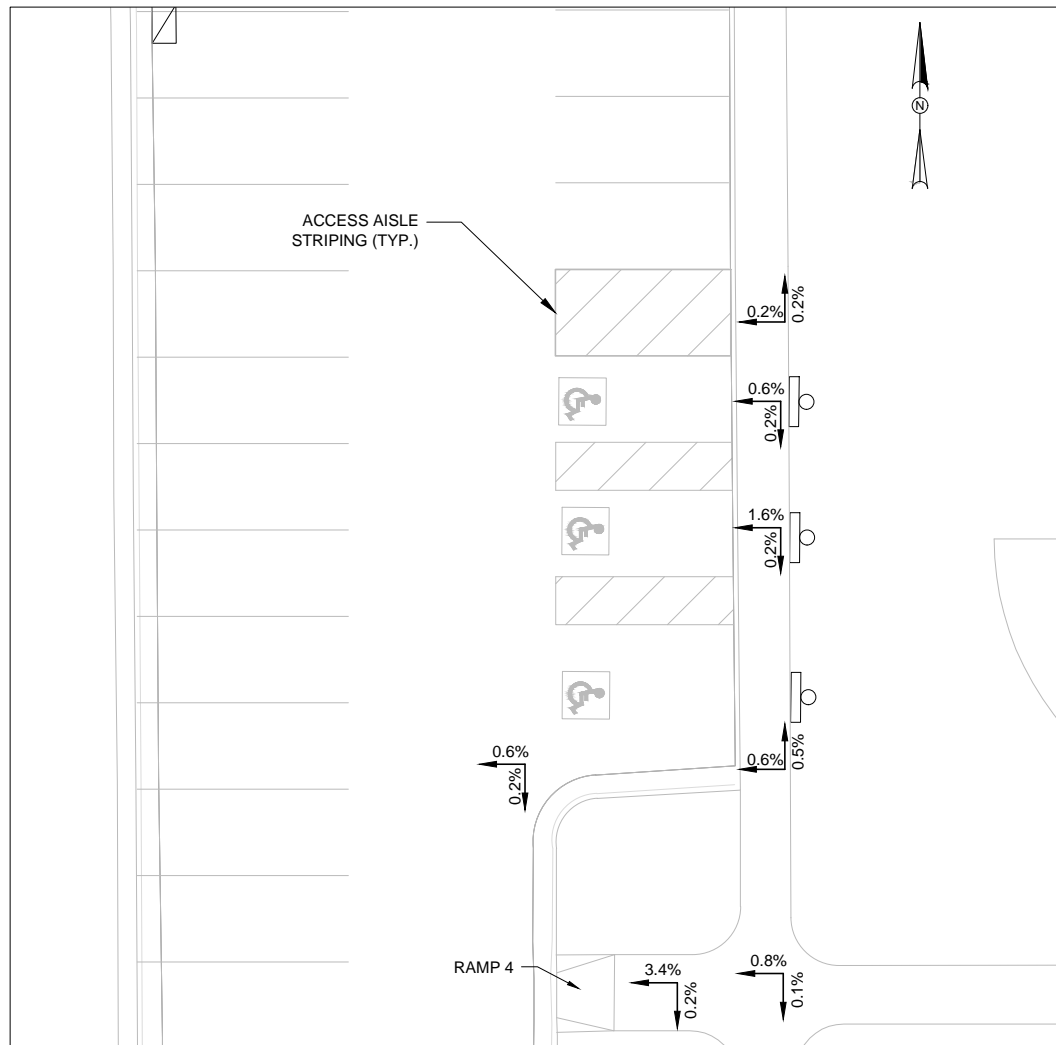

AREA 1

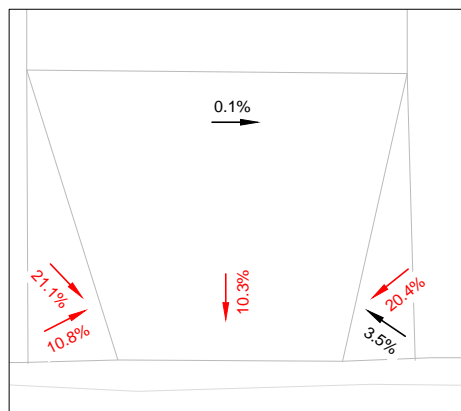

RAMP 4

NOTES:

- CURB RAMPS WITH NON-COMPLIANT SLOPE SHALL BE REMOVED AND REPLACED ACCORDING TO CURB RAMP DETAIL ON SHEET 9.
- NON-COMPLIANT ADA PARKING STALLS AND ACCESS AISLES SHALL BE REGRADED TO MEET ADA SPECIFICATIONS ON SHEET 2.
- EXISTING ADA STALLS IN AREA 2 TO BE REMOVED. SEE AREAS 1 AND 3 FOR PROPOSED ADA AREAS.
- NON-COMPLIANT ADA PARKING STALLS AND ACCESS AISLES SHALL BE REGRADED TO MEET BUT NOT EXCEED THE FOLLOWING SLOPES:

ELEMENT	CROSS SLOPE	RUNNING SLOPE
CONCRETE ACCESSIBLE ROUTES	1.8%	4.8%
ASPHALT ACCESSIBLE ROUTES	1.5%	4.5%
CONCRETE ACCESSIBLE PARKING	1.8%	1.8%
ASPHALT ACCESSIBLE AREA	1.5%	1.5%
CONCRETE RAMPS	1.8%	7.8%
CONCRETE LANDINGS AND DOORWAYS	1.8%	1.8%

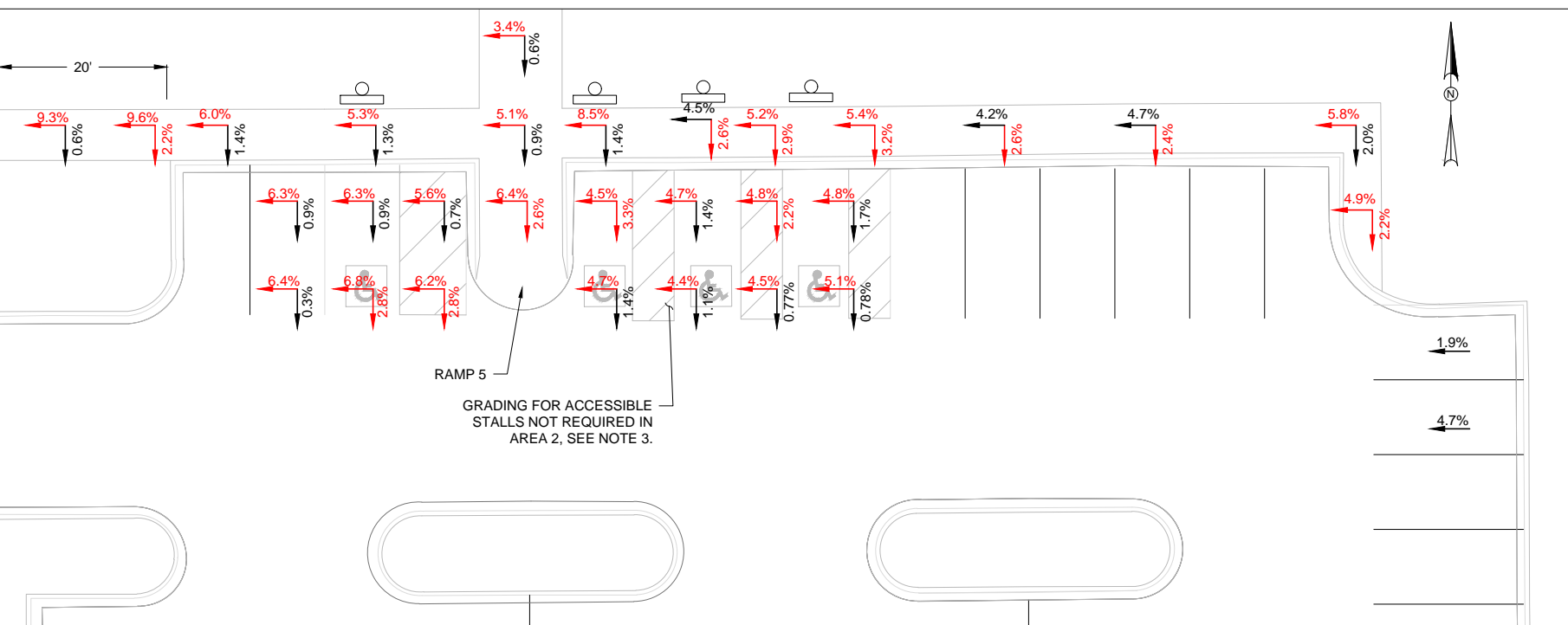

AREA 2

EXISTING LEGEND

EXISTING CONDITIONS

X.X% NON-COMPLIANT SLOPE

X.X% EXISTING SLOPE

KEY LOCATION MAP

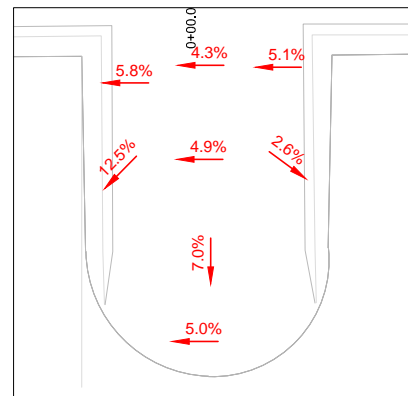
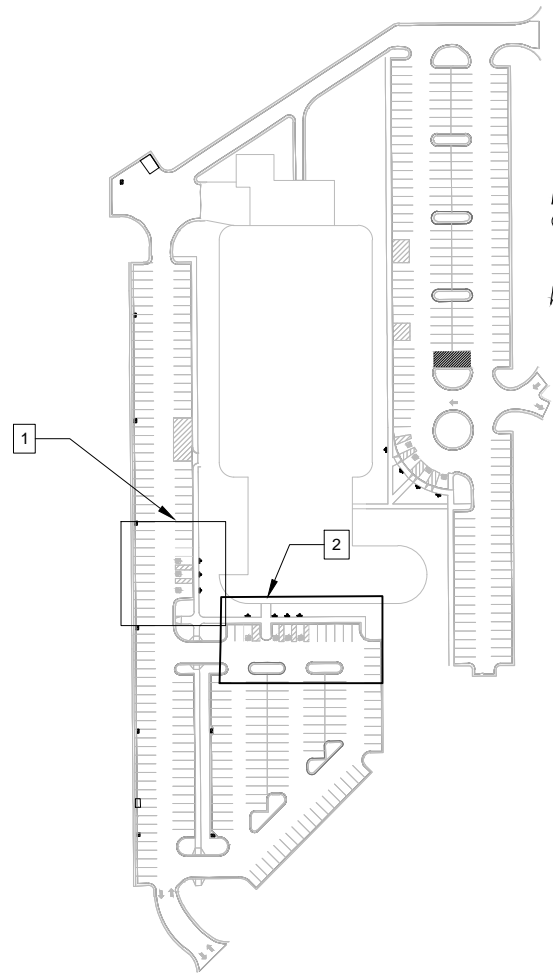

RAMP 5



1801 California Street, Suite #1100
 Denver, CO 80202
 Phone: 303-237-6601
 www.kleinfelder.com



REVISIONS

REV	DESCRIPTION	DSN	CHK	DATE
		DW	APP	

RFC 10/28/2016

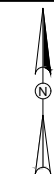

SCALE VERIFICATION
 THIS BAR IS 1 INCH IN LENGTH ON ORIGINAL DRAWING
 IF IT'S NOT 1 INCH ON THIS SHEET ADJUST YOUR SCALES ACCORDINGLY

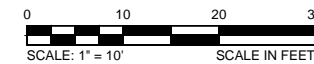

ORIGINAL DRAWING SIZE IS 22 x 34

ADA CHECK PLAN



LIBRARY 21C
 1175 CHAPEL HILLS DR.
 COLORADO SPRINGS, CO 80920

BID DOCUMENT DRAWINGS

PROJECT NO.	20164613	SHEET
ISSUE DATE	10/26/2016	
CURRENT REVISION	-	
DESIGNED BY	MRS	
DRAWN BY	MRS	
CHECKED BY	JTM	
APPROVED BY	SJMS	



REVISIONS

REV	DESCRIPTION	DESIGNER	CHECKED BY	DATE

RFC 10/28/2016

SCALE VERIFICATION

THIS BAR IS 1 INCH IN LENGTH ON ORIGINAL DRAWING

IF IT'S NOT 1 INCH ON THIS SHEET ADJUST YOUR SCALES ACCORDINGLY



ORIGINAL DRAWING SIZE IS 22 x 34

SIDEWALK RAMP



LIBRARY 21C
1175 CHAPEL HILLS DR.
COLORADO SPRINGS, CO 80920

BID DOCUMENT DRAWINGS

PROJECT NO.	20164613	SHEET	7
ISSUE DATE	10/26/2016		
CURRENT REVISION	-		
DESIGNED BY	MRS		
DRAWN BY	JM		
CHECKED BY	JTM		
APPROVED BY	SJMS		

NOTES:

1. SIDEWALK TO BE PCC APPROVED CITY MIX.
2. SEE DETAIL 3, SHEET 9 FOR SIDEWALK THICKNESS.
3. SIDEWALK JOINTS PER DETAILS ON SHEET 10.
4. EXISTING SIDEWALK TO BE SAWCUT AND JOINT PLACED AT TRANSITION TO NEW SIDEWALK PER DETAILS ON SHEET 10.
5. MATCH EXISTING GRADE AT LIMITS OF SIDEWALK. SEE ADA NOTES ON SHEET 2 FOR ADA COMPLIANCE CRITERIA.
6. SUBGRADE PREPARATION DETAILS ARE PRESENTED IN THE KLEINFELDER PAVEMENT EVALUATION REPORT PPLD LIBRARY 21C DATED AUGUST 10, 2016.

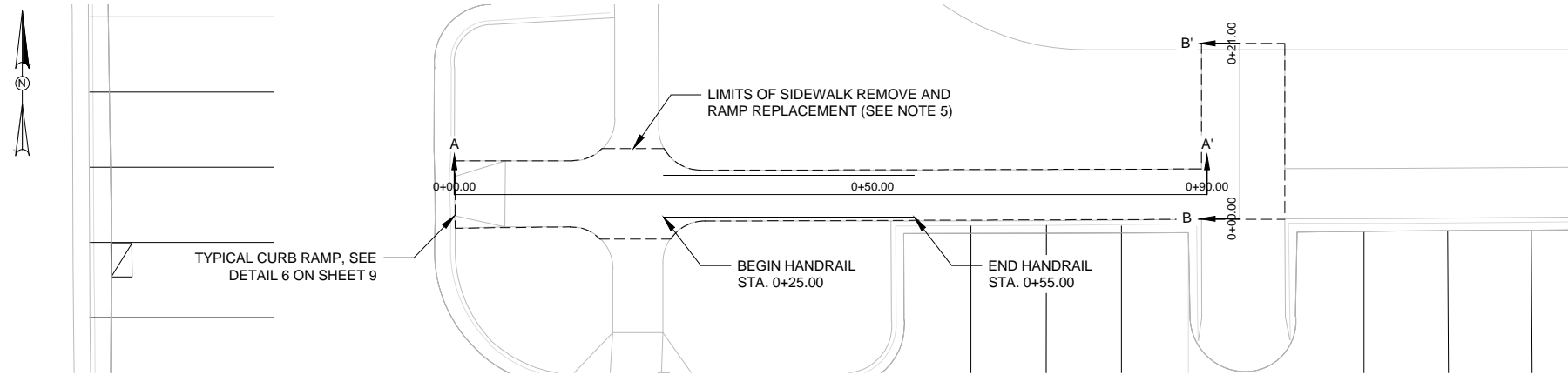

PLAN VIEW (SCALE 1" = 10')

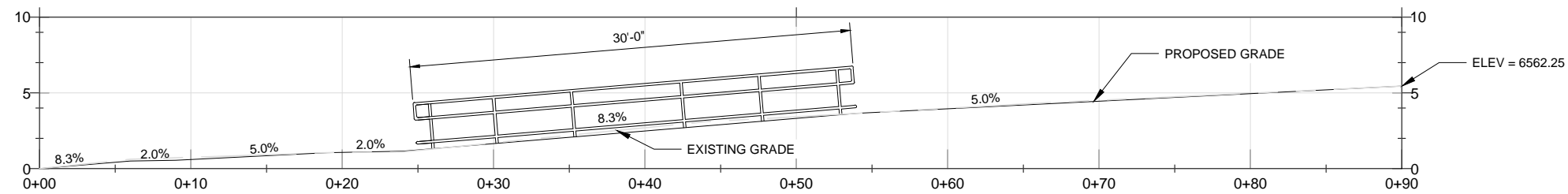

NOTE:
ELEV AT 0+00 = ELEV 6556.8

PROFILE VIEW A-A' (SCALE 1" = 5')

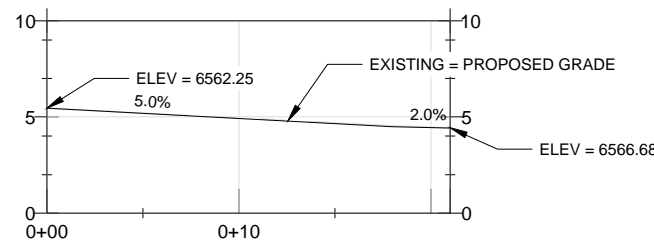

NOTE:
ELEV AT 0+00 = ELEV 6556.8

PROFILE VIEW B-B' (SCALE 1" = 5')

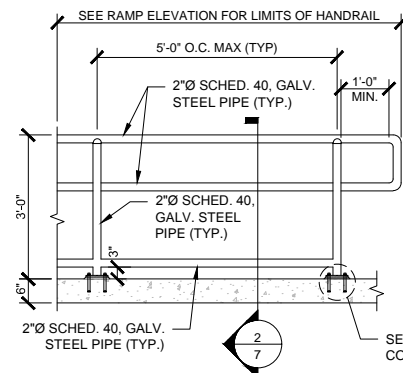

NOTES:

1. RAILING TO BE GALVANIZED ACCORDING TO ASTM A123
2. ALL FABRICATION AND WELDING TO BE SMOOTH AND FREE OF BLOW-OUTS, HOLES, PITS, OR SLAG
3. HANDRAIL MANUFACTURER SHALL DESIGN HANDRAIL FOR THE FOLLOWING DESIGN LOADS:
-50 PLF OR 200 LBS IN ANY DIRECTION, WHICHEVER IS GREATER

1 HANDRAIL DETAIL
SCALE: 1/2" = 1'-0"

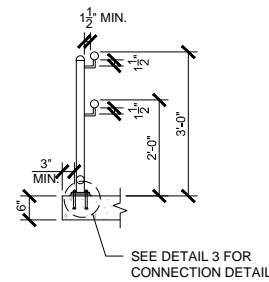

2 HANDRAIL SECTION
SCALE: 1/2" = 1'-0"

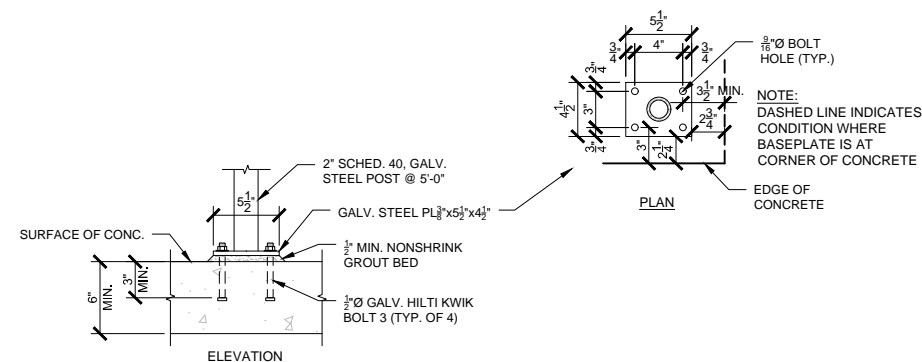

3 HANDRAIL CONNECTION DETAILS
SCALE: 1-1/2" = 1'-0"

CAD FILE: W:\20164613 - Library 21c Pavement Repair Plan\21c Technical And CADD Figures\Library 21c 80% Plans.dwg LAYOUT: 8 Phasing Plan

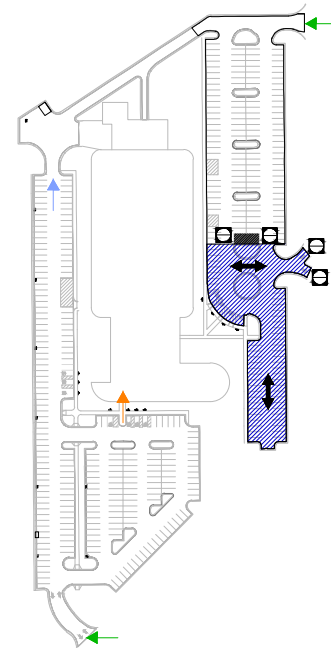

PHASE 1

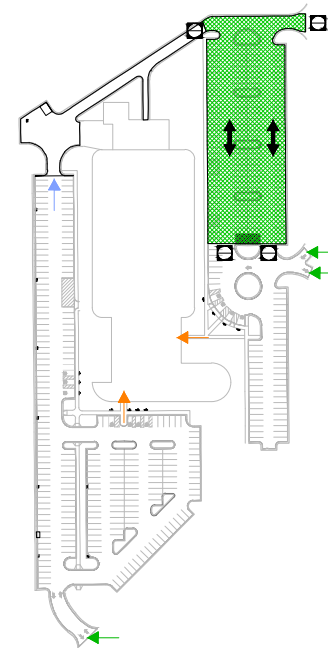

PHASE 2

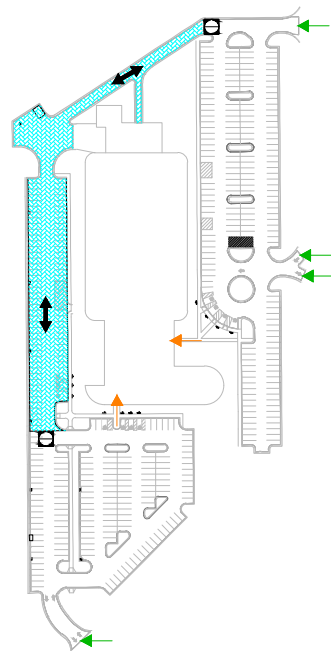

PHASE 3

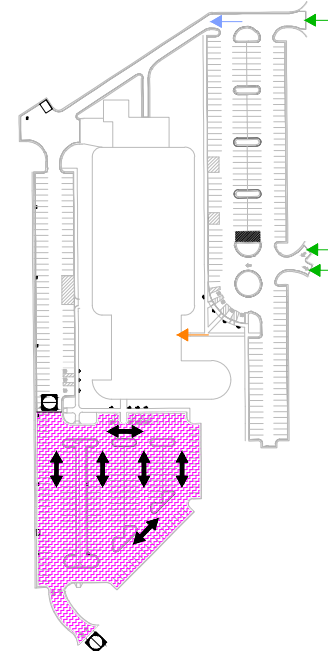

PHASE 4

PHASING PLAN LEGEND

- PHASE 1 CONSTRUCTION
- PHASE 2 CONSTRUCTION
- PHASE 3 CONSTRUCTION
- PHASE 4 CONSTRUCTION
- DELINEATOR & RIBBON PLACEMENT
- DO NOT ENTER SIGN
- PUBLIC ACCESS ROUTE
- PUBLIC SITE ACCESS
- DELIVERY ACCESS
- PAVING DIRECTION



1801 California Street, Suite #1100
Denver, CO 80202
Phone: 303-237-6601
www.kleinfelder.com



REVISIONS

REV	DESCRIPTION	DSN DWN	CHK APP	DATE

RFC 10/28/2016

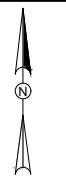

SCALE VERIFICATION
THIS BAR IS 1 INCH IN LENGTH
ON ORIGINAL DRAWING

IF IT'S NOT 1 INCH ON THIS
SHEET ADJUST YOUR
SCALES ACCORDINGLY

0 150 300 450
SCALE: 1" = 150' SCALE IN FEET

ORIGINAL DRAWING SIZE IS 22 x 34

PHASING PLAN



LIBRARY 21C
1175 CHAPEL HILLS DR.
COLORADO SPRINGS, CO 80920

BID DOCUMENT DRAWINGS

PROJECT NO.	20164613	SHEET	8
ISSUE DATE	10/26/2016		
CURRENT REVISION	-		
DESIGNED BY	MRS		
DRAWN BY	MRS		
CHECKED BY	JTM		
APPROVED BY	SJMS		8 of 10



REVISIONS

REV	DESCRIPTION	DSN DW	CHK APP	DATE

RFC 10/28/2016

SCALE VERIFICATION

THIS BAR IS 1 INCH IN LENGTH ON ORIGINAL DRAWING

IF IT'S NOT 1 INCH ON THIS SHEET ADJUST YOUR SCALES ACCORDINGLY

ORIGINAL DRAWING SIZE IS 22 x 34

DETAILS

LIBRARY 21C
PRIOR PEAK LIBRARY DISTRICT

LIBRARY 21C
1175 CHAPEL HILLS DR.
COLORADO SPRINGS, CO 80920

BID DOCUMENT DRAWINGS

PROJECT NO.	20164613	SHEET	
ISSUE DATE	10/26/2016		
CURRENT REVISION	-		
DESIGNED BY	MRS		
DRAWN BY	JM		9
CHECKED BY	JTM		
APPROVED BY	SJMS		

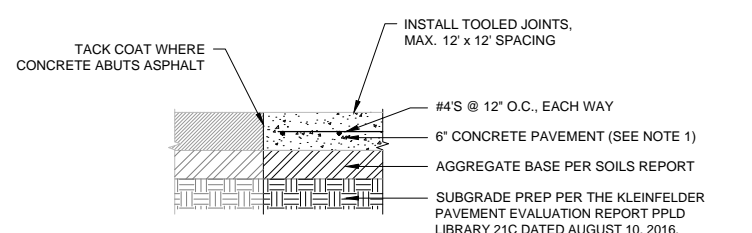

- NOTES**
- HIGH EARLY STRENGTH 4200 PSI MIX, SUCH AS CDOT CLASS E OR CITY OF COLORADO SPRINGS APPROVED EQUIVALENT, MINIMUM 3-DAY STRENGTH OF 2,500 PSI.
 - BASE COURSE TO CONFORM TO CDOT STANDARDS FOR BASE COURSE COMPACTED TO 95% OF THE MODIFIED PROCTOR (ASTM D-1557) MAXIMUM DRY DENSITY.
 - THE PAVEMENT REHABILITATION DETAILS ARE PRESENTED IN THE KLEINFELDER PAVEMENT EVALUATION REPORT PPLD LIBRARY 21C DATED AUGUST 10, 2016.
 - ALL SUBGRADE AND PAVEMENT OPERATIONS AND MATERIALS THAT ARE NOT INCLUDED IN THE ABOVE REFERENCE SHALL MEET THE MINIMUM REQUIREMENTS CDOT STANDARDS AND SPECIFICATION MANUAL.

1 LOADING DOCK CONCRETE PAVEMENT
N.T.S

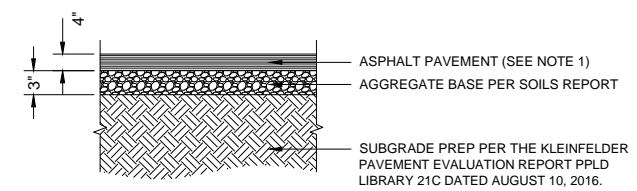

- NOTES**
- CONTRACTOR SHALL SUBMIT MIX DESIGN TO THE ENGINEER FOR APPROVAL SEVEN (7) DAYS PRIOR TO THE BEGINNING OF PAVEMENT OPERATION. THE MIX DESIGN SHALL BE DEVELOPED USING THE CDOT SUPERPAVE MIX DESIGN PROCEDURES PER SECTION 403.03 OF THE "STANDARD SPECIFICATION FOR ROAD AND BRIDGE CONSTRUCTION". SUBGRADE COMPACTION PER SOILS REPORT.
 - BASE COURSE TO CONFORM TO CDOT STANDARDS FOR BASE COURSE COMPACTED TO 95% OF THE MODIFIED PROCTOR (ASTM D-1557) MAXIMUM DRY DENSITY.
 - PROVIDE TACK COAT BETWEEN BASE COURSE AND SURFACE COURSE.

2 PARKING LOT ASPHALT PAVEMENT
N.T.S

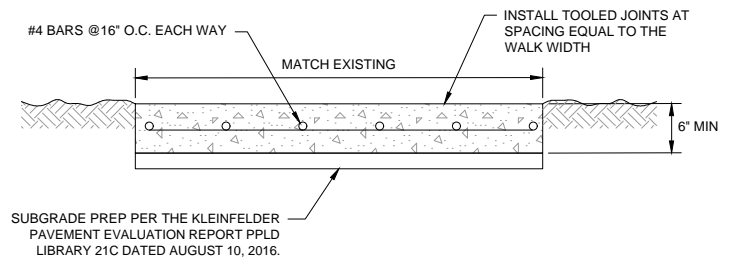

3 NEW SIDEWALK
N.T.S

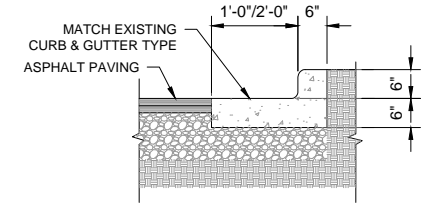

- NOTES**
- SLOPE ON GUTTER PLATE SHOULD BE 1/4" PER FOOT MIN. SLOPE AND SHALL PERMIT POSITIVE DRAINAGE TO DRAINAGE STRUCTURES. SLOPE TOWARDS OR AWAY FROM CURB AS REQUIRED.
 - EXPANSION JOINT: PLACED AT ENDS OF ALL RADII, 5' ON EACH SIDE OF DRAINAGE STRUCTURES, AND 45' MAX. SPACING IN STRAIGHT CURB AND GUTTER. PROVIDE #6x18" LONG SMOOTH STEEL DOWEL BARS WITH 1" DIA. GREASE CAP THROUGH EXPANSION JOINTS. (3/4" BITUMINOUS FILLER MATERIAL).
 - CONTRACTION JOINT: PROVIDE 2" DEEP x 1/4" WIDE CONTRACTION JOINTS AT 15' INTERVALS. 2'-6" LONG TIE BAR ON 2'-6" CENTERS SHALL BE PROVIDED WHEN CURB IS ADJACENT TO PCC PAVEMENT.
 - PROVIDE 2#6 x 2'-6" LONG TIE BARS TO CONNECT EXISTING AND NEW CURB AND GUTTER. REMOVE FORMS AS EARLY AS POSSIBLE. BRUSH TOP AND FACE OF CURBS TO REMOVE ALL IMPERFECTIONS.
 - ALL RADII SHALL BE TRUE ARCS.
 - LIGHT BROOM FINISH ON ALL EXTERIOR CONCRETE.

4 CONCRETE CURB AND GUTTER
N.T.S

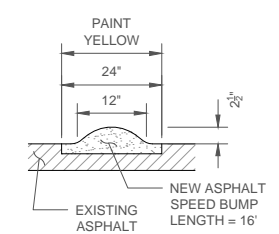

5 SPEED BUMP DETAIL
N.T.S

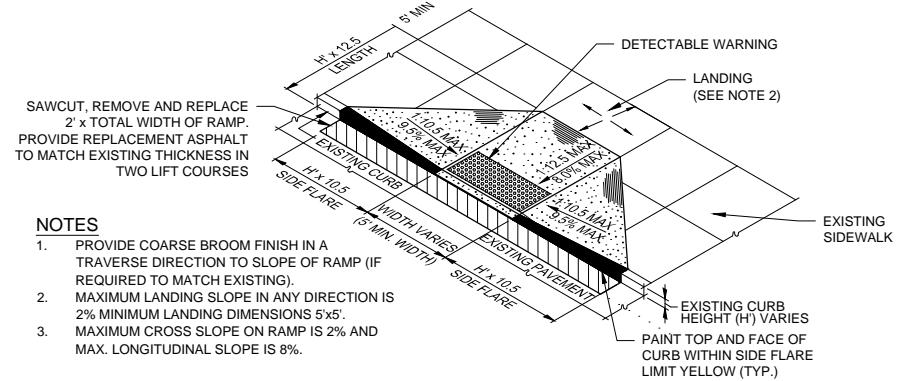

- NOTES**
- PROVIDE COARSE BROOM FINISH IN A TRAVERSE DIRECTION TO SLOPE OF RAMP (IF REQUIRED TO MATCH EXISTING).
 - MAXIMUM LANDING SLOPE IN ANY DIRECTION IS 2% MINIMUM LANDING DIMENSIONS 5x5'.
 - MAXIMUM CROSS SLOPE ON RAMP IS 2% AND MAX. LONGITUDINAL SLOPE IS 8%.

6 CONCRETE CURB RAMP
N.T.S

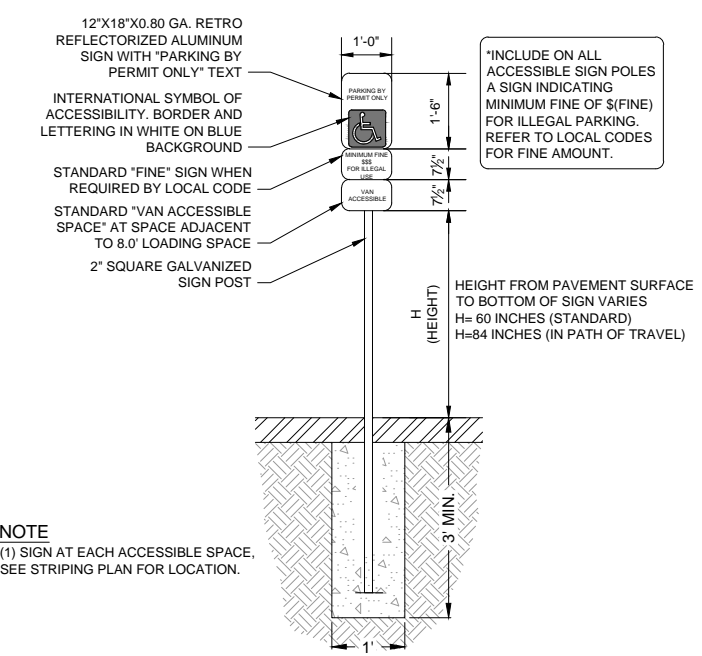

7 ADA SIGN DETAIL
N.T.S

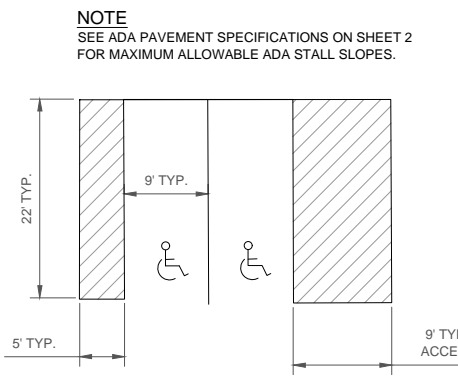

8 TYPICAL ADA STALL
N.T.S

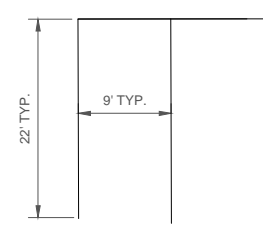

9 TYPICAL STALL
N.T.S

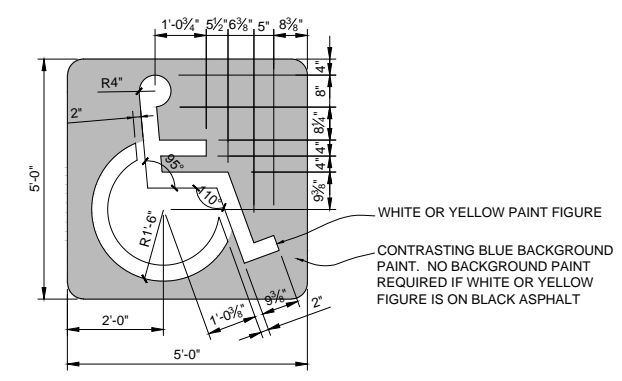

- INTERNATIONAL SYMBOL OF ACCESSIBILITY NOTES**
- SYMBOL TO BE CENTERED ON WIDTH OF PARKING STALL.
 - BOTTOM OF SYMBOL TO BE LOCATED 2'-6" FROM ACCESS DRIVE, INTO PARKING SPACE.
 - SYMBOL IS REQUIRED TO CONTRAST WITH BACKGROUND.

10 ADA SYMBOL
N.T.S

CAD FILE: W320164613 - Library 21c Pavement Repair Plan 21c Technical Information 2.8 Technical And CADD Figures Library 21c 90% Plans.dwg LAYOUT: Details 1



REVISIONS

REV	DESCRIPTION	DESIGNED	CHECKED	DATE

RFC 10/28/2016

SCALE VERIFICATION

THIS BAR IS 1 INCH IN LENGTH
ON ORIGINAL DRAWING

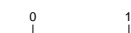

IF IT'S NOT 1 INCH ON THIS
SHEET ADJUST YOUR
SCALES ACCORDINGLY

ORIGINAL DRAWING SIZE IS 22 x 34

DETAILS

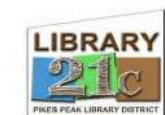

LIBRARY 21C
1175 CHAPEL HILLS DR.
COLORADO SPRINGS, CO 80920

BID DOCUMENT DRAWINGS

PROJECT NO.	20164613	SHEET	10
ISSUE DATE	10/26/2016		
CURRENT REVISION	-		
DESIGNED BY	MRS		
DRAWN BY	MRS		
CHECKED BY	JTM		
APPROVED BY	SJMS		10 of 10

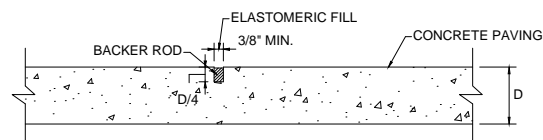

11 STANDARD CONTROL JOINT (SAW CUT)
N.T.S

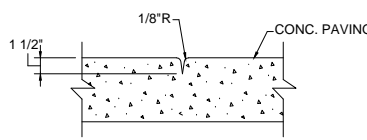

12 STANDARD TOOL JOINT
N.T.S

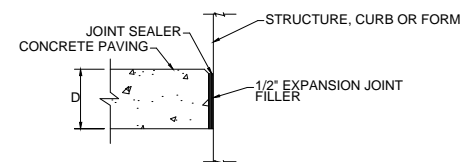

13 STANDARD ISOLATION JOINT
N.T.S

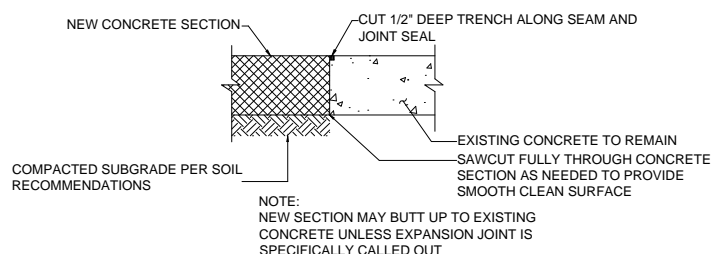

14 STANDARD SAWCUT JOINT FOR
NEW CONCRETE DETAIL
N.T.S